



**Austral Lock**

Expect to be protected



**ELEGANCE**  
**PUSH**  
**2Go**

**External Keyless  
Privacy Locking**

# About Us

Excellence in design and a rigorous approach to quality have given Austral Lock a reputation for reliability in premium security hardware for both doors and windows.

Founded in 1982, Austral Lock is a wholly Australian-owned and operated manufacturer specialising in premium security hardware for both doors and windows. With manufacturing, storage and development facilities in the Melbourne region, Austral Lock is one of few manufacturers in the industry that is still proudly Australian made, providing complete control over process and quality. Our local production facility allows us to provide custom solutions and an extensive range of options to meet the needs of our customers.

Austral Lock is committed to producing the finest quality product possible. Our commitment to research and development ensures higher quality, better techniques and continuous improvement. Emphasis is placed not only on the function of the product, but also ease of installation and product durability. We take pride in our wide range of patented, innovative products that provide end users with improved functionality and reliability. With Austral Lock, you can expect to be protected.

Austral Lock is a division of Gainsborough Hardware Industries.

## Colours

All Austral Lock products are available in the wide range of powder coated colours listed below. Special colours (SP) beyond this range are also available, please contact Austral Lock directly regarding this as special conditions and fees apply. Special colours which do not incur an additional fee or conditions are listed below. The colours on this chart are as close to the actual colours as printing allows, they should be used only as an approximation of the actual powder coated colours. Samples are available on request.



Black Satin

**Colour Code:**  
BLST

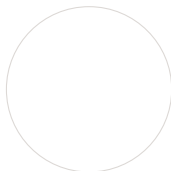

White Gloss

**Colour Code:**  
WHGL



Precious Silver Pearl

**Colour Code:**  
PSIL

Special colours that do not incur a fee



Magnolia

**Colour Code:**  
MAG



Paperbark

**Colour Code:**  
PBRK



White Birch

**Colour Code:**  
WBIR



Stone Beige Matt

**Colour Code:**  
SBMT



Primrose Gloss

**Colour Code:**  
PRGL



Hawthorn Green

**Colour Code:**  
HG



Doeskin Satin

**Colour Code:**  
DSST



DUNE

**Colour Code:**  
DUNE



Monument

**Colour Code:**  
MON



Anotec Dark Grey

**Colour Code:**  
ANGR



Woodland Grey

**Colour Code:**  
WDGR



Notre Dame Grey

**Colour Code:**  
NOTR



Brown Gloss

**Colour Code:**  
BR



Precious Bronze Pearl

**Colour Code:**  
GS



Deep Ocean Drive

**Colour Code:**  
DPOC



Surfmist

**Colour Code:**  
SFM



# Elegance Push2Go Hinged Security Screen Door Lock



Conventional hinged security screen door locks often feature two stage key locking – the first stage is privacy and the second stage is deadlocking. The all new Elegance Push2Go replaces the need for a key to engage privacy locking with a push button so you can “Push2Go”. The door is then privacy locked (not deadlocked) from the outside. The door can be unlocked from the inside with the turnsnib and unlocked from the outside with a key.

## Product Features

- ✓ Features the patented Push2Go functionality- Exterior keyless privacy lock with interior unlocking via turn snib
- ✓ Enhanced resistance to forced entry via a notch in the latch bolt that engages a profiled strike plate aperture
- ✓ Self-adjusting catch plate automatically compensates for building movement and door carriage wear to ensure correct latching after continued use
- ✓ Jemmy resistant strike plate is designed to deform under attack to enable it to remain engaged with the bolt even as the door is jemmied away from the door jamb
- ✓ Combine with multipoint kits to create a triple lock for extra strength and resistance to jemmy
- ✓ Available in a range of powder coat finishes (refer to pg. 2)
- ✓ Easy installation for both new and retrofit applications
- ✓ Fits into industry standard door cut outs
- ✓ Suits Aluminium door frames 19mm to 25mm thick
- ✓ Suits both left and right closing doors
- ✓ Designed and manufactured in Australia
- ✓ 7 year limited tarnish resistant and 10 year limited mechanical guarantee
- ✓ Detailed installation instructions can be downloaded from [www.ausloc.com](http://www.ausloc.com)
- ✓ Suitable for both pin and wafer cylinders



## Line Drawings

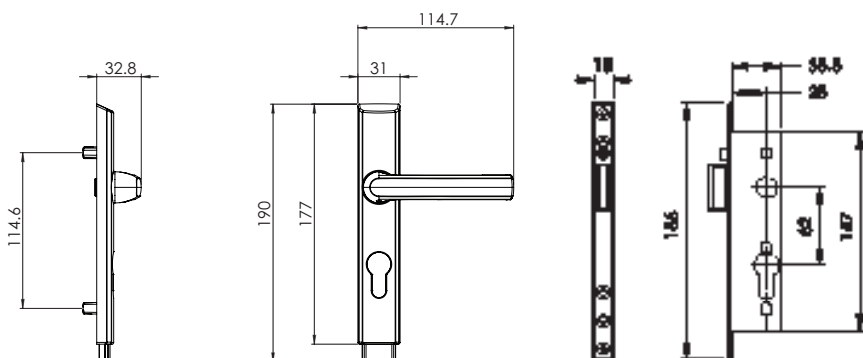

## Ordering Codes

Code	Description		
<b>LOCKS</b>			
ELP2G/BLST	Elegance Push2Go Black Satin		
ELP2G/PSIL	Elegance Push2Go Precious Silver Pearl		
ELP2G/SP	Elegance Push2Go Special Colour		
ELP2G/WHGL	Elegance Push2Go White Gloss		
<b>MULTIPOINT KITS - CABLE</b>		Top cut out	Bottom cut out
EKIT/H	High cable operated multipoint kit for Elegance series	682mm	826mm
EKIT/L	Low cable operated multipoint kit for Elegance series	826mm	682mm
EKIT/P	Pool height cable operated multipoint kit for Elegance series	375mm	961mm
<b>MULTIPOINT KITS - ROD</b>			
H14R/H	High rod operated multipoint kit for Elegance series	682mm	826mm
H14R/L	Low rod operated multipoint kit for Elegance series	826mm	682mm
H14R/P	Pool height rod operated multipoint kit for Elegance series	375mm	961mm
<b>CYLINDERS</b>			
AAC4 / Key Code	AA 5-pin double cylinder with C4 keyway		
AAG / Key Code	AA 5-pin double cylinder with GR9 keyway		
AAC4LHTT / Key Code	AA 5-pin C4 cylinder with interior thumb-turn for left hand doors		
AAC4RHTT / Key Code	AA 5-pin C4 cylinder with interior thumb-turn for right hand doors		
W2000 / KA or KD	W2000 wafer cylinder		

To find out more about the Austral Lock products, contact us on **13 14 18** or visit **[www.ausloc.com](http://www.ausloc.com)**

### Head Office

31-33 Alfred Street  
Blackburn, VIC 3130

Sales Hotline: 13 14 18  
Sales Fax Hotline: 13 18 14

P0 Box 330  
Blackburn, VIC 3130

Email: [ghisales@gwagroup.com.au](mailto:ghisales@gwagroup.com.au)

